



AN-196

Inbyggingsmottagare
På/Av, 2 kanaler

TEKNISK DATA

AN-179	
Strömkälla	220-240 V~50 Hz
Max. last	2 x 1000 W R
Frekvens	Z-Wave (868,42 MHz)
Räckvidd	upp till 30 m
Strömförbrukning	< 1 W (standby)
IP klassificering	Inomhusbruk
Mått (B x H x D)	43 x 42 x 16 mm

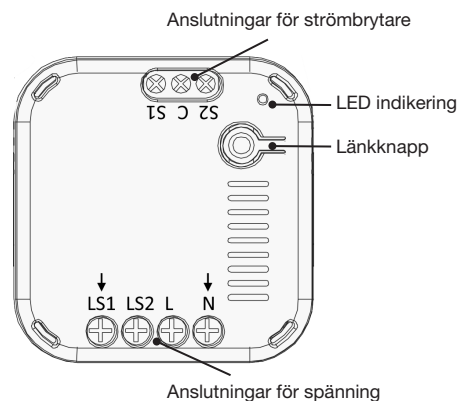

Inbyggingsmottagare för fast installation. Liten och kompakt storlek för placering i kopplings- eller apparatdosa. Kan anslutas till befintlig strömbrytare. Mottagaren behöver både fas och nolla. Mottagaren har full kompatibilitet med Z-Wave Plus standarden.

SÄKERHET

Läs igenom hela instruktionen först. Anlita fackman vid behov. Nexa kan ej hållas ansvarig om produkten används till annat än den är designad för eller om instruktionen inte följs.

Anslut aldrig lampor eller utrustning som överskrider mottagarens maximala angivna belastning, det kan leda till fel, kortslutning eller brand.

Försök inte att reparera produkten. Produkten innehåller inga reparerbara delar.

INSTALLATION

Säkerställ att ledarna är spänningsfria genom att slå av strömmen i elcentralen.

Koppla Fas till L, Last/Tändtråd till LS1/LS2 och Nollledare till N. AN-196 kan kopplas till strömbrytare, även återfjädrande, för styrning, se även kopplingsschema.

Observera att strömbrytare anslutna till AN-196 måste vara potentialfria, dvs. helt isolerade från 230V.

ANSLUT TILL ETT Z-WAVE NÄTVERK

Smart start / Autoinklusion:

AN-196 har stöd för SmartStart-funktion, inklusion startar automatiskt när enheten spänningssätts och upprepas med dynamiska intervall så länge enheten inte ingår i ett Z-Wave-nätverk. Z-Wave SmartStart är baserat på Z-Wave SDK 6.8x och kräver att controller har stöd för detta.

Om controller inte stöder SmartStart-funktion kan den här enheten läggas till Z-Wave-nätverket med manuell inklusion, eller genom att skanna DSK QR-koden eller ange en 5-siffrig "Device Specific Key" (DSK) på begäran av gatewayen.

1. Sätt Z-Wave kontrollern i inklusionsläge (se kontrollerns manual)
2. Anslut AN-196 till spänning och enheten inkluderas.

Manuell Inklusion:

1. Sätt Z-Wave kontrollern i inklusionsläge (se kontrollerns manual)
2. Tryck 3 ggr på Länknappen inom 1,5 sekunder

Exklusion:

1. Sätt Z-Wave kontrollern i exklusionsläge (se kontrollerns manual)
2. Tryck 3 ggr på Länknappen inom 1,5 sekunder.

Fabriksåterställning:

1. Tryck 3 ggr på Länknappen inom 1,5 sekunder.
2. Inom 1 sekund från steg 1 ovan, tryck och håll inne länknappen till LED slocknar, ca 5 sekunder.
3. Node ID är raderat och enheten fabriksåterställd.

ANVÄNDNING

Utgångarna på AN-196 kan styras trådlöst med Z-Wave controller och med anslutna strömbrytare. Se manualen till din Z-Wave controller för mer information.

LAST	MAX EFFEKT
Glödlampor & Resistiv last (230V)	1000W / 220-240V
Halogenlampor (230V)	450W / 220-240V
LED- & lågenergilampor (230V)	130W / 220-240V (40W x 3)

SÄKERHET OCH INFORMATION

Räckvidd inomhus: upp till 30 m (optimala förhållanden). Räckvidden är starkt beroende av lokala förhållanden, till exempel om det finns metaller i närheten. Exempelvis har den tunna metallbeläggning i energiglas med låg emissivitet negativ inverkan på radiosignalernas räckvidd. Det kan finnas begränsningar för användningen av enheten utanför EU. Om tillämpligt bör du kontrollera att enheten överensstämmer med lokala föreskrifter.

Max belastning: Anslut aldrig lampor eller utrustning som överskrider mottagarens maximala belastning. Det kan leda till fel, kortslutning eller brand.

Livsuppehållande utrustning: Använd aldrig Nexas produkter till livsuppehållande utrustning eller andra apparater där fel eller störningar kan få livshotande följder.

Störningar: Alla trådlösa enheter kan drabbas av störningar som kan påverka prestandan och räckvidden. Det minsta avståndet mellan två mottagare bör därför vara åtminstone 50 cm

Reparation: Försök inte att reparera produkten. Den innehåller inga reparerbara delar.

Vattentäthet: Produkten är inte vattentät. Se till att den alltid är torr. Fukt gör att elektroniken inuti fräts sönder och kan leda till kortslutning, fel och risk för elstötar.

Rengöring: Rengör produkten med en torr trasa. Använd inte kemikalier, lösningsmedel eller starka rengöringsmedel.

Miljö: Utsätt inte produkten för stark värme eller kyla, eftersom det kan skada eller förkorta de elektroniska kretsarnas livslängd.

KOPPLINGSSCHEMA

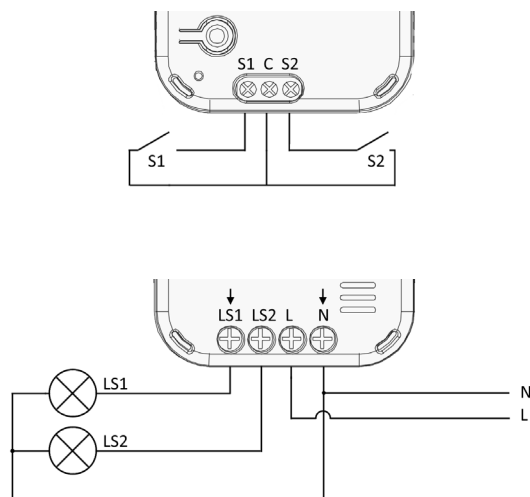

PROGRAMMING

Z-WAVE GROUP SUPPORT

AN-196 relay module supports three Z-wave Association Groups:
Group 1: Association with 5 Controller nodes.
Group 2: Association with 5 nodes.
Group 3: Association with 5 nodes.

Group 1 commands:

- When the unit is powered up for first time, a Notification Report will be sent to the node of Group 1.
- When performing Factory Reset, a Device Reset Locally Notification will be sent to the node of Group 1.
- When relay is activated through the switch, the unit will send a Binary Switch Report to the node of Group 1.

Group 2 commands:

- When switch 1 is pressed, a BASIC SET command containing a value will be sent to the node of Group 2 (When relay is off, Basic Set Value=0x00, when relay is on, Basic Set Value=0xFF).

Group 3 commands:

- When switch 2 is pressed, a BASIC SET command containing a value will be sent to the node of Group 3 (When relay is off, Basic Set Value=0x00, when relay is on, Basic Set Value=0xFF).

Z-WAVE PLUS INFO (Root/Endpoint1/Endpoint2)

Role Type	Node Type	Installer Icon	User Icon
Slave Always On	Z-Wave Plus node	On/Off Power Switch	On/Off Power Switch Wall outlet

VERSION

Protocol Library	3 (Slave_Enhance_232_Library)
Protocol Version	6.04 (6.81.03)

MANUFACTURER

Manufacturer ID	Product Type	Product ID
0x0060	0x0004	0x000E

AGI (ASSOCIATION GROUP INFORMATION) TABLE

Group	Profile	Command Class & Command (List) N bytes	Group Name (UTF-8)
1	General:NA	Binary Switch Report, Notification Report, Device Reset Locally Notification	Lifeline
2	Control	Basic Set	On/Off control Button 1
3	Control	Basic Set	On/Off control Button 2

BASIC COMMANDS

Command	Description
Basic Get	Inquire about the status of the device
Basic Report	Report the status of the device.
Basic Set	Set the status of the device.(Value=0XFF (ON), 0x00 (OFF))

NOTIFICATION

Event	Type	Event	Event Parameters Length
Power applied for first time	0x08	0x01	0x00

CONFIGURATION

The configurable values are as following:

Parameter Number	Parameter Function	Size	Range	Default
1	Switch 1 Type	1	0~1	0 (0: Momentary 1: Toggle)
2	Switch 2 Type	1	0~1	0 (0: Momentary 1: Toggle)
3	Relay 1 Auto Off Time	4	0~43200(sec.)	0 (Not auto off) (Max 12 hours)
4	Relay 2 Auto Off Time	4	0~43200(sec.)	0 (Not auto off) (Max 12 hours)
5	Set whether to remember the last status of Relay 1	1	1/0	1:Remember (0: do not remember)
6	Set whether to remember the last status of Relay 2	1	1/0	1:Remember (0: do not remember)

COMMAND CLASSES

The module supports Command Classes including -

- COMMAND_CLASS_ZWAVEPLUS_INFO_V2
- COMMAND_CLASS_ASSOCIATION_V2
- COMMAND_CLASS_ASSOCIATION_GRP_INFO
- COMMAND_CLASS_MULTI_CHANNEL_ASSOCIATION_V2
- COMMAND_CLASS_MULTI_CHANNEL
- COMMAND_CLASS_TRANSPORT_SERVICE_V2
- COMMAND_CLASS_VERSION_V2
- COMMAND_CLASS_MANUFACTURER_SPECIFIC_V2
- COMMAND_CLASS_DEVICE_RESET_LOCALLY
- COMMAND_CLASS_POWERLEVEL
- COMMAND_CLASS_SECURITY
- COMMAND_CLASS_SECURITY_2
- COMMAND_CLASS_SUPERVISION
- COMMAND_CLASS_FIRMWARE_UPDATE_MD_V4
- COMMAND_CLASS_NOTIFICATION_V4
- COMMAND_CLASS_CONFIGURATION
- COMMAND_CLASS_SWITCH_BINARY

END POINT 1/2

- COMMAND_CLASS_ZWAVEPLUS_INFO_V2
- COMMAND_CLASS_SWITCH_BINARY
- COMMAND_CLASS_ASSOCIATION_V2
- COMMAND_CLASS_ASSOCIATION_GRP_INFO
- COMMAND_CLASS_MULTI_CHANNEL_ASSOCIATION_V2
- COMMAND_CLASS_SUPERVISION

ADDITIONAL COMMAND CLASSES SUPPORTED

- Binary Switch: Refer to Basic.
- Multi Channel: To control 2 relay independently.
- Firmware Update: For OTA function.



AN-196
Built-in receiver
On/Off, 2 channels

TECHNICAL DATA

AN-179	
Power source	220-240 V~50 Hz
Max. charge	2 x 1000 W R
Frequency	Z-Wave (868.42 MHz)
Range	up to 30 m
Power consumption	< 1 W (standby)
IP rating	Indoor use
Dimensions (W x H x D)	43 x 42 x 16 mm

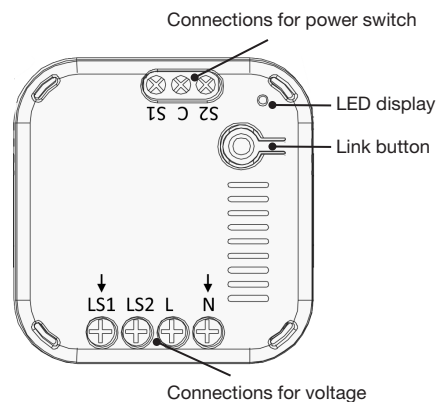

Built-in receiver for permanent installation. Small, compact size for placing in a junction box or switchbox. Can be connected to existing switch. The receiver needs both phase and neutral. The receiver is fully compatible with the Z-Wave Plus standard.

SAFETY

Read through the entire instruction first. Engage a professional if so required. Nexa cannot be held liable if the product is used for any purpose other than the one for which it is designed, or if there is failure to comply with the instruction.

Never connect bulbs or equipment exceeding the receiver's maximum stated load – this may lead to faults, short-circuiting or fire.

Do not attempt to repair the product. The product contains no repairable parts.

INSTALLATION

Make sure that the conductors are powered down by turning off the power in the distribution box.

Connect Phase to L, Load/Ignition wire to LS1/LS2 and Zero Conductor to N.

AN-196 can be connected to power switches, even momentary switches, for control, also see wiring diagram.

Please note that switches connected to AN-196 must be potential free, i.e. fully insulated from 230 V.

CONNECT TO A Z-WAVE NETWORK

Smart start / Auto-inclusion:

AN-196 has support for the Smart Start functions, inclusion starts automatically when the unit is powered up and repeats at a dynamic interval for as long as the unit is not part of a Z-Wave network. Z-Wave SmartStart is based on Z-Wave SDK 6.8x and requires the controller to have support for this.

If the controller does not support the SmartStart function, the unit can be added to the Z-Wave network by manual inclusion, or by scanning the DSC QR code, or by entering a 5-digit "Device Specific Code" (DSC) when requested by the gateway.

1. Put the Z-Wave controller in inclusion mode (see the controller's manual)
2. Connect AN-196 to voltage and the unit is included.

Manual Inclusion:

1. Put the Z-Wave controller in inclusion mode (see the controller's manual)
2. Press 3 times on the Link button within 1.5 seconds

Exclusion:

1. Put the Z-Wave controller in exclusion mode (see the controller's manual)
2. Press 3 times on the Link button within 1.5 seconds.

Restore to factory settings:

1. Press 3 times on the Link button within 1.5 seconds.
2. Within 1 second after step 1 above, press and hold down the link button until the LED goes out, approx. 5 seconds.
3. Node ID is deleted and the unit restored to factory settings.

USE

The outputs on AN-196 can be wirelessly controlled by a Z-Wave controller and by connected power switch Consult the manual for your Z-Wave controller for more information.

LOAD	MAX POWER
Incandescent bulbs % Resistive loads (230 V)	1000W / 220-240 V
Halogen lights (230 V)	450W / 220-240 V
LED & Low energy bulbs (230 V)	130W / 220-240 V (40 W x 3)

SAFETY AND INFORMATION

Range indoors: up to 30 m (optimal conditions). The range is very dependent on the local conditions, for example, if there are metals in the vicinity. For example, the thin metal coating in energy glass with low emissivity has a negative influence on the range of the radio signals. There may be restrictions on the use of the unit outside the EU. If appropriate, you should check that the unit complies with local regulations.

Max load: Never connect lights or equipment that exceed the receiver's maximum load. This could lead to faults, short-circuiting or fire.

Life-support equipment: Never use Nexa's products with life-support equipment or other devices where faults or interference could have life-threatening consequences.

Interference: All wireless units can suffer from interference that can affect the performance and range. For this reason, the minimum distance between two receivers should be at least 50 cm

Repair: Do not attempt to repair the product. It does not contain any repairable parts.

Waterproofing: The product is not waterproof. Make sure it is dry at all times. Damp causes the electronics inside to corrode and this could lead to short-circuiting, faults and a risk for electric shocks.

Cleaning: Clean the product with a dry cloth. Do not use chemicals, solvents or strong cleaning agents.

Environment: Do not expose the product to intense heat or cold, because it could damage or shorten the service life of the electric circuits.

WIRING DIAGRAM

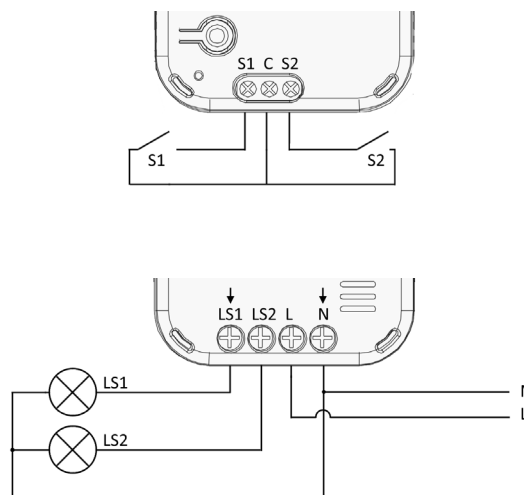

PROGRAMMING

Z-WAVE GROUP SUPPORT

AN-196 relay module supports three Z-wave Association Groups:

Group 1: Association with 5 Controller nodes.

Group 2: Association with 5 nodes.

Group 3: Association with 5 nodes.

Group 1 commands:

- When the unit is powered up for first time, a Notification Report will be sent to the node of Group 1.
- When performing Factory Reset, a Device Reset Locally Notification will be sent to the node of Group 1.
- When relay is activated through the switch, the unit will send a Binary Switch Report to the node of Group 1.

Group 2 commands:

- When switch 1 is pressed, a BASIC SET command containing a value will be sent to the node of Group 2 (When relay is off, Basic Set Value=0x00, when relay is on, Basic Set Value=0xFF).

Group 3 commands:

- When switch 2 is pressed, a BASIC SET command containing a value will be sent to the node of Group 3 (When relay is off, Basic Set Value=0x00, when relay is on, Basic Set Value=0xFF).

Z-WAVE PLUS INFO (Root/Endpoint1/Endpoint2)

Role Type	Node Types	Installer Icon	User Icon
Slave Always On	Z-Wave Plus node	On/Off Power Switch	On/Off Power Switch Wall outlet

VERSION

Protocol Library	3 (Slave_Enhance_232_Library)
Protocol Version	6.04 (6.81.03)

MANUFACTURER

Manufacturer ID	Product Type	Product ID
0x0060	0x0004	0x000E

AGI (ASSOCIATION GROUP INFORMATION) TABLE

Group	Profile	Command Class & Command (List) N bytes	Group Name (UTF-8)
1	General:NA	Binary Switch Report, Notification Report, Device Reset Locally Notification	Lifeline
2	Control	Basic Set	On/Off control Button 1
3	Control	Basic Set	On/Off control Button 2

BASIC COMMANDS

Command	Description
Basic Get	Inquire about the status of the device
Basic Report	Report the status of the device.
Basic Set	Set the status of the device.(Value=0xFF (ON), 0x00 (OFF))

NOTIFICATION

Events	Type	Events	Event Parameters Length
Power applied for first time	0x08	0x01	0x00

CONFIGURATION

The configurable values are as following:

Parameter Number	Parameter Function	Size	Range	Default
1	Switch 1 Type	1	0~1	0 (0: Momentary 1: Toggle)
2	Switch 2 Type	1	0~1	0 (0: Momentary 1: Toggle)
3	Relay 1 Auto Off Time	4	0~43200(sec.)	0 (Not auto off) (Max 12 hours)
4	Relay 2 Auto Off Time	4	0~43200(sec.)	0 (Not auto off) (Max 12 hours)
5	Set whether to remember the last status of Relay 1	1	1/0	1:Remember (0: do not remember)
6	Set whether to remember the last status of Relay 2	1	1/0	1:Remember (0: do not remember)

COMMAND CLASSES

The module supports Command Classes including -

- COMMAND_CLASS_ZWAVEPLUS_INFO_V2
- COMMAND_CLASS_ASSOCIATION_V2
- COMMAND_CLASS_ASSOCIATION_GRP_INFO
- COMMAND_CLASS_MULTI_CHANNEL_ASSOCIATION_V2
- COMMAND_CLASS_MULTI_CHANNEL
- COMMAND_CLASS_TRANSPORT_SERVICE_V2
- COMMAND_CLASS_VERSION_V2
- COMMAND_CLASS_MANUFACTURER_SPECIFIC_V2
- COMMAND_CLASS_DEVICE_RESET_LOCALLY
- COMMAND_CLASS_POWERLEVEL
- COMMAND_CLASS_SECURITY
- COMMAND_CLASS_SECURITY_2
- COMMAND_CLASS_SUPERVISION
- COMMAND_CLASS_FIRMWARE_UPDATE_MD_V4
- COMMAND_CLASS_NOTIFICATION_V4
- COMMAND_CLASS_CONFIGURATION
- COMMAND_CLASS_SWITCH_BINARY

END POINT 1/2

- COMMAND_CLASS_ZWAVEPLUS_INFO_V2
- COMMAND_CLASS_SWITCH_BINARY
- COMMAND_CLASS_ASSOCIATION_V2
- COMMAND_CLASS_ASSOCIATION_GRP_INFO
- COMMAND_CLASS_MULTI_CHANNEL_ASSOCIATION_V2
- COMMAND_CLASS_SUPERVISION

ADDITIONAL COMMAND CLASSES SUPPORTED

- Binary Switch: Refer to Basic.
- Multi Channel: To control 2 relay independently.
- Firmware Update: For OTA function.

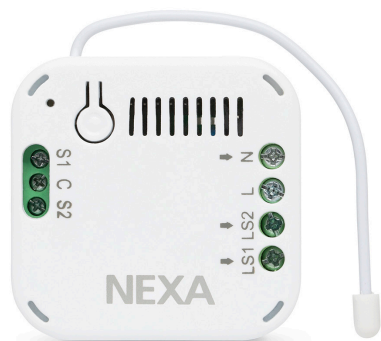

AN-196 Innbyggingsmottaker På/Av, 2 kanaler

TEKNISKE SPESIFIKASJONER

AN-179	
Strømkilde	220–240 V–50 Hz
Maks. belastning	2 x 1000 W R
Frekvens	Z-Wave (868,42 MHz)
Rekkevidde	opptil 30 m
Strømforkbruk	< 1 W (ventemodus)
IP-klassifisering	Innendørs bruk
Mål (B x H x D)	43 x 42 x 16 mm

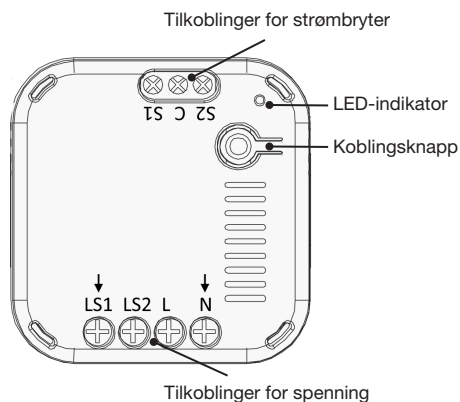

NORSK

Innbyggingsmottaker for fast installasjon. Liten og kompakt størrelse for plassering i koblings- eller apparatboks. Kan kobles til eksisterende strømbryster. Mottakeren må ha både fase og jording. Mottakeren er fullstendig kompatibel med Z-Wave Plus-standarden.

SIKKERHET

Les gjennom hele instruksjonen først. Kontakt fagperson ved behov. Nexa kan ikke holdes ansvarlig hvis produktet brukes til noe annet enn det er beregnet på eller hvis instruksjonene ikke følges.

Du må aldri koble til lamper eller utstyr som overskrider mottakerens maksimalt angitte belastning. Det kan føre til feil, kortslutning eller brann.

Ikke gjør forsøk på å reparere produktet. Produktet inneholder ingen reparerbare deler.

INSTALLASJON

Kontroller at ledningene er spenningsfrie ved å slå av strømmen i fordelingsboksen.

Koble fase til L, belastning/tenntråd til LS1/LS2 og nulleleder til N. AN-196 kan kobles til strømbryster, også tilbakeførende, for styring, se også koblingsskjema.

Vær oppmerksom på at strømbryster koblet til AN-196 må være potensialfrie, dvs. helt isolerte fra 230 V.

KOBLE TIL ET Z-WAVE-NETTVERK

Smart start/automatisk inklusjon:

AN-196 har støtte for SmartStart-funksjon – inklusjon starter automatisk når enheten spenningssettes og gjentas ved dynamiske intervaller så lenge enheten ikke er inkludert i et Z-Wave-nettverk. Z-Wave SmartStart er basert på Z-Wave SDK 6.8x, og krever at styreenheten har støtte for dette.

Hvis styreenheten ikke støtter SmartStart-funksjon, kan denne enheten legges til Z-Wave-nettverket ved manuell inklusjon, eller ved å skanne DSK QR-koden eller angi en 5-sifret "Device Specific Key" (DSK) på forespørsel fra gatewayen.

1. Sett Z-Wave-styreenheten i inklusjonsmodus (se styreenhetens håndbok)
2. Koble AN-196 til spenning, så inkluderes enheten.

Manuell inklusjon:

1. Sett Z-Wave-styreenheten i inklusjonsmodus (se styreenhetens håndbok)
2. Trykk 3 ganger på koblingsknappen innen 1,5 sekund

Eksklusjon:

1. Sett Z-Wave-styreenheten i eksklusjonsmodus (se styreenhetens håndbok)
2. Trykk 3 ganger på koblingsknappen innen 1,5 sekund.

Tilbakestilling av fabrikkinnstillinger:

1. Trykk 3 ganger på koblingsknappen innen 1,5 sekund.
2. Innen 1 sekund etter trinn 1 over trykker du på og holder inne koblingsknappen til LED-lampen slås av, ca. 5 sekunder.
3. Node-ID er slettet og enheten tilbakestilt til fabrikkinnstillinger.

BRUK

Utgangene på AN-196 kan styres trådløst med Z-Wave-styreenhet og tilkoblede strømbryster. Mer informasjon finnes i håndboken for Z-Wave-styreenheten.

BELASTNING	MAKS. EFFEKT
Lyspærer og resistiv belastning (230 V)	1000W/220–240 V
Halogenpærer (230 V)	450W/220–240 V
LED- og lavenergipærer (230 V)	130W/220–240 V (40 W x 3)

SIKKERHET OG INFORMASJON

Rekkevidde innendørs: opptil 30 m (optimale forhold). Rekkevidden avhenger i betydelig grad av lokale forhold, som hvorvidt det finnes metall i nærheten. Det tynne metallbelegget i energiglass med lav emissivitet har for eksempel en negativ virkning på radiosignalenes rekkevidde. Det kan finnes begrensninger for bruk av enheten utenfor EU. Om aktuelt, bør du kontrollere at enheten overholder lokale forskrifter.

Maks. belastning: Koble aldri til lamper eller utstyr som overskrider mottakerens maksimale belastning. Dette kan føre til feil, kortslutning eller brann.

Livreddende utstyr: Bruk aldri Nexa-produkter til livreddende utstyr eller andre apparater der feil eller forstyrrelser kan ha livstruende følger.

Forstyrrelser: Alle trådløse enheter kan utsettes for forstyrrelser, som kan påvirke både ytelsen og rekkevidden. Den minste avstanden mellom to mottakere bør derfor være minst 50 cm.

Reparasjon: Ikke gjør forsøk på å reparere produktet. Produktet inneholder ingen deler som kan repareres.

Vanntetthet: Produktet er ikke vanntett. Påse at det alltid holdes tørt. Fuktighet gjør at elektronikken inni enheten ødelegges, og kan føre til kortslutning, feil og fare for elektrisk støt.

Rengjøring: Rengjør produktet med en tørr klut. Bruk aldri kjemikalier, løsemidler eller aggressive rengjøringsmidler.

Miljø: Produktet skal ikke utsettes for sterk varme eller kulde, ettersom dette kan skade eller forkorte de elektroniske kretsens levetid.

KOBLINGSSKJEMA

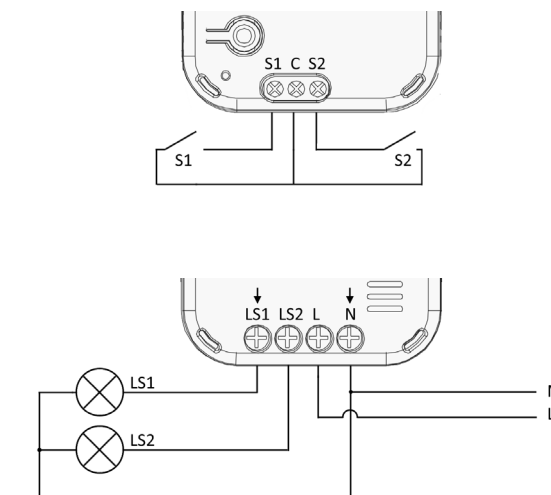

PROGRAMMING

Z-WAVE GROUP SUPPORT

AN-196 relay module supports three Z-wave Association Groups:

Group 1: Association with 5 Controller nodes.

Group 2: Association with 5 nodes.

Group 3: Association with 5 nodes.

Group 1 commands:

- When the unit is powered up for first time, a Notification Report will be sent to the node of Group 1.
- When performing Factory Reset, a Device Reset Locally Notification will be sent to the node of Group 1.
- When relay is activated through the switch, the unit will send a Binary Switch Report to the node of Group 1.

Group 2 commands:

- When switch 1 is pressed, a BASIC SET command containing a value will be sent to the node of Group 2 (When relay is off, Basic Set Value=0x00, when relay is on, Basic Set Value=0xFF).

Group 3 commands:

- When switch 2 is pressed, a BASIC SET command containing a value will be sent to the node of Group 3 (When relay is off, Basic Set Value=0x00, when relay is on, Basic Set Value=0xFF).

Z-WAVE PLUS INFO (Root/Endpoint1/Endpoint2)

Role Type	Node Types	Installer Icon	User Icon
Slave Always On	Z-Wave Plus node	On/Off Power Switch	On/Off Power Switch Wall outlet

VERSION

Protocol Library	3 (Slave_Enhance_232_Library)
Protocol Version	6.04 (6.81.03)

MANUFACTURER

Manufacturer ID	Product Type	Product ID
0x0060	0x0004	0x000E

AGI (ASSOCIATION GROUP INFORMATION) TABLE

Group	Profile	Command Class & Command (List) N bytes	Group Name (UTF-8)
1	General:NA	Binary Switch Report, Notification Report, Device Reset Locally Notification	Lifeline
2	Control	Basic Set	On/Off control Button 1
3	Control	Basic Set	On/Off control Button 2

BASIC COMMANDS

Command	Description
Basic Get	Inquire about the status of the device
Basic Report	Report the status of the device.
Basic Set	Set the status of the device.(Value=0XFF (ON), 0x00 (OFF))

NOTIFICATION

Events	Type	Events	Event Parameters Length
Power applied for first time	0x08	0x01	0x00

CONFIGURATION

The configurable values are as following:

Parameter Number	Parameter Function	Size	Range	Default
1	Switch 1 Type	1	0–1	0 (0: Momentary 1: Toggle)
2	Switch 2 Type	1	0–1	0 (0: Momentary 1: Toggle)
3	Relay 1 Auto Off Time	4	0–43200(sec.)	0 (Not auto off) (Max 12 hours)
4	Relay 2 Auto Off Time	4	0–43200(sec.)	0 (Not auto off) (Max 12 hours)
5	Set whether to remember the last status of Relay 1	1	1/0	1:Remember (0: do not remember)
6	Set whether to remember the last status of Relay 2	1	1/0	1:Remember (0: do not remember)

COMMAND CLASSES

The module supports Command Classes including -

- COMMAND_CLASS_ZWAVEPLUS_INFO_V2
- COMMAND_CLASS_ASSOCIATION_V2
- COMMAND_CLASS_ASSOCIATION_GRP_INFO
- COMMAND_CLASS_MULTI_CHANNEL_ASSOCIATION_V2
- COMMAND_CLASS_MULTI_CHANNEL
- COMMAND_CLASS_TRANSPORT_SERVICE_V2
- COMMAND_CLASS_VERSION_V2
- COMMAND_CLASS_MANUFACTURER_SPECIFIC_V2
- COMMAND_CLASS_DEVICE_RESET_LOCALLY
- COMMAND_CLASS_POWERLEVEL
- COMMAND_CLASS_SECURITY
- COMMAND_CLASS_SECURITY_2
- COMMAND_CLASS_SUPERVISION
- COMMAND_CLASS_FIRMWARE_UPDATE_MD_V4
- COMMAND_CLASS_NOTIFICATION_V4
- COMMAND_CLASS_CONFIGURATION
- COMMAND_CLASS_SWITCH_BINARY

END POINT 1/2

- COMMAND_CLASS_ZWAVEPLUS_INFO_V2
- COMMAND_CLASS_SWITCH_BINARY
- COMMAND_CLASS_ASSOCIATION_V2
- COMMAND_CLASS_ASSOCIATION_GRP_INFO
- COMMAND_CLASS_MULTI_CHANNEL_ASSOCIATION_V2
- COMMAND_CLASS_SUPERVISION

ADDITIONAL COMMAND CLASSES SUPPORTED

- Binary Switch: Refer to Basic.
- Multi Channel: To control 2 relay independently.
- Firmware Update: For OTA function.



AN-196

Sisäänrakennettu vastaanotin
Päälle / pois päältä, 2 kanavaa

TEKNISET TIEDOT

AN-179	
Virtalähde	220-240 V ~ 50 Hz
Maksimikuorma	2 x 1 000 W R
Taajuus	Z-Wave (868,42 MHz)
Kantama	jopa 30 m
Virrankulutus	< 1 W (valmiustila)
IP-luokitus	Sisäkäyttö
Mitat (L x K x S)	43 x 42 x 16 mm

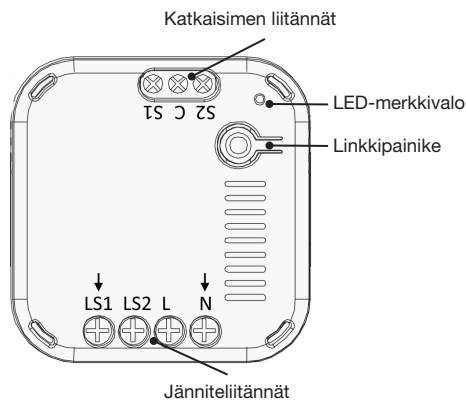

Sisäänrakennettu vastaanotin kiinteään asennukseen. Pieni ja kompakti sijoitettavaksi kytkentä- tai laiterasiaan. Voidaan liittää olemassa olevaan katkaisimeen. Vastaanotin tarvitsee sekä vaiheen että nollan. Vastaanotin on täysin yhteensopiva Z-Wave Plus -standardin kanssa.

TURVALLISUUS

Lue koko käyttöohje ennen käyttöä. Kysy tarvittaessa neuvoa asiantuntijalta. Nexaa ei voida pitää vastuullisena, jos tuotetta käytetään muuhun kuin sille suunniteltuun tarkoitukseen tai jos ohjeita ei noudateta.

Älä koskaan liitä lamppeja tai varusteita, jotka ylittävät vastaanottimen ilmoitetun maksimikuorman, sillä muutoin seurauksena voi olla vikaantuminen, oikosulku tai tulipalo.

Älä yritä korjata tuotetta. Tuotteessa ei ole korjattavia osia.

ASENNUS

Varmista johtimien jännitteettömyys kytkemällä virta pois päältä sähkökeskuksesta.

Liitä vaihe L:ään, kuuma/sytytyslanka LS1/LS2:een ja nollajohto N:ään. AN-196 voidaan liittää ohjausta varten katkaisimeen, myös palautusjousiseen (ks. kytkentäkaavio). Ota huomioon, että AN-196:een liitettyjen katkaisinten on oltava potentiaalivapaita, ts. täysin eristettyjä 230 V:sta.

LIITÄNTÄ Z-WAVE-VERKKOON

Smart Start / Automaattinen liittäminen:

AN-196 tukee Smart Start -toimintoa, ts. liittäminen käynnistyy automaattisesti, kun laitteen jännitteensyöttö alkaa, ja se toistuu niin kauan kuin laite ei ole Z-Wave-verkossa. Z-Wave Smart Start pohjautuu Z-Wave SDK 6.8x:ään, ja vaatimuksena on, että ohjain tukee tätä.

Jos ohjain ei tue Smart Start -toimintoa, laite voidaan liittää Z-Wave-verkkoon manuaalisesti, skannaamalla DSK QR -koodi tai syöttämällä 5-numeroinen Device Specific Key (DSK) -tunnus yhdyskäytävän sitä pyytäessä.

1. Aseta Z-Wave-ohjain liittämistilaan (ks. ohjaimen ohjekirja)
2. Liitä AN-196 jännitteeseen, niin laite liitetään.

Manuaalinen liittäminen:

1. Aseta Z-Wave-ohjain liittämistilaan (ks. ohjaimen ohjekirja)
2. Paina 3 kertaa linkkipainiketta 1,5 sekunnin kuluessa.

Irrottaminen:

1. Aseta Z-Wave-ohjain irrotustilaan (ks. ohjaimen ohjekirja)
2. Paina 3 kertaa linkkipainiketta 1,5 sekunnin kuluessa.

Palautus tehdasasetuksiin:

1. Paina 3 kertaa linkkipainiketta 1,5 sekunnin kuluessa.
2. Paina 1 sekunnin kuluessa vaiheesta 1 linkkipainiketta ja pidä se painettuna, kunnes LED-merkkivalo sammuu eli noin 5 sekuntia.
3. Node-tunniste on poistettu, ja laite on palautettu tehdasasetuksiin.

KÄYTTÖ

AN-196:n lähtöjä voidaan ohjata langattomasti Z-Wave-ohjaimella ja liitetyllä katkaisimella.

Katso lisätietoja Z-Wave-ohjaimen käyttöohjeesta.

KUORMA	MAKSIMITEHO
Hehkulamput ja resistiivinen kuorma (230 V)	1 000 W / 220-240 V
Halogeenilamput (230 V)	450 W / 220-240 V
LED- ja energiansäästölamput (230 V)	130 W / 220-240 V (40 W x 3)

TURVALLISUUS JA TIEDOT

Kantama sisällä: Enintään 30 m (optimaalisissa olosuhteissa). Kantama riippuu paljon paikallisista olosuhteista, muun muassa siitä, onko lähistöllä metallia. Esimerkiksi alhaisen emissiokyvyn omaavan energialasin ohut metallipinnoite lyhentää radiosignaalin kantamaa. EU:n ulkopuolella laitteen käytölle voi olla rajoituksia. Varmista sopivuus tarkistamalla, että laite vastaa paikallisia määräyksiä.

Maksimikuorma: Älä koskaan liitä lamppeja tai laitteita, jotka ylittävät vastaanottimen maksimikuorman. Muutoin seurauksena voi olla vika, oikosulku tai tulipalo.

Elämää ylläpitävät laitteet: Älä koskaan käytä Nexan tuotteita elämää ylläpitävien laitteiden tai muiden sellaisten laitteiden kanssa, joissa viat tai toimintahäiriöt voivat aiheuttaa hengenvaarallisia seurauksia.

Toimintahäiriöt: Kaikissa langattomissa laitteissa voi esiintyä toimintahäiriöitä, jotka voivat vaikuttaa suorituskykyyn ja kantamaan. Sen vuoksi kahden vastaanottimen välisen etäisyyden on oltava vähintään 50 cm.

Korjaaminen: Älä yritä korjata tuotetta. Siinä ei ole korjattavia osia.

Vesitiiviyys: Tuote ei ole vesitiivis. Varmista, että se on aina kuiva. Kosteus syövyttää elektroniikkaa ja voi aiheuttaa oikosulun, vian tai sähköiskuvaaran.

Puhdistaminen: Puhdista tuote kuivalla rievulla. Älä käytä kemikaaleja, liuottimia tai voimakkaita puhdistusaineita.

Ympäristö: Älä altista tuotetta kuumuudelle tai kylmyydelle, koska se voi vaurioittaa tuotetta tai lyhentää elektronisten piirien käyttöikää.

KYTKENTÄKAAVIO

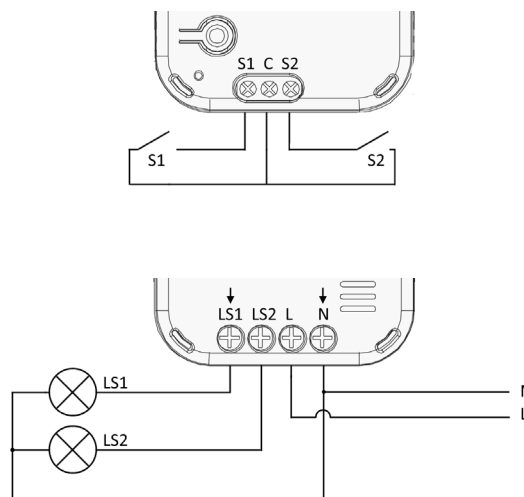

PROGRAMMING

Z-WAVE GROUP SUPPORT

AN-196 relay module supports three Z-wave Association Groups:

Group 1: Association with 5 Controller nodes.

Group 2: Association with 5 nodes.

Group 3: Association with 5 nodes.

Group 1 commands:

- When the unit is powered up for first time, a Notification Report will be sent to the node of Group 1.
- When performing Factory Reset, a Device Reset Locally Notification will be sent to the node of Group 1.
- When relay is activated through the switch, the unit will send a Binary Switch Report to the node of Group 1.

Group 2 commands:

- When switch 1 is pressed, a BASIC SET command containing a value will be sent to the node of Group 2 (When relay is off, Basic Set Value=0x00, when relay is on, Basic Set Value=0xFF).

Group 3 commands:

- When switch 2 is pressed, a BASIC SET command containing a value will be sent to the node of Group 3 (When relay is off, Basic Set Value=0x00, when relay is on, Basic Set Value=0xFF).

Z-WAVE PLUS INFO (Root/Endpoint1/Endpoint2)

Role Type	Node Types	Installer Icon	User Icon
Slave Always On	Z-Wave Plus node	On/Off Power Switch	On/Off Power Switch Wall outlet

VERSION

Protocol Library	3 (Slave_Enhance_232_Library)
Protocol Version	6.04 (6.81.03)

MANUFACTURER

Manufacturer ID	Product Type	Product ID
0x0060	0x0004	0x000E

AGI (ASSOCIATION GROUP INFORMATION) TABLE

Group	Profile	Command Class & Command (List) N bytes	Group Name (UTF-8)
1	General:NA	Binary Switch Report, Notification Report, Device Reset Locally Notification	Lifeline
2	Control	Basic Set	On/Off control Button 1
3	Control	Basic Set	On/Off control Button 2

BASIC COMMANDS

Command	Description
Basic Get	Inquire about the status of the device
Basic Report	Report the status of the device.
Basic Set	Set the status of the device.(Value=0xFF (ON), 0x00 (OFF))

NOTIFICATION

Events	Type	Events	Event Parameters Length
Power applied for first time	0x08	0x01	0x00

CONFIGURATION

The configurable values are as following:

Parameter Number	Parameter Function	Size	Range	Default
1	Switch 1 Type	1	0-1	0 (0: Momentary 1: Toggle)
2	Switch 2 Type	1	0-1	0 (0: Momentary 1: Toggle)
3	Relay 1 Auto Off Time	4	0-43200(sec.)	0 (Not auto off) (Max 12 hours)
4	Relay 2 Auto Off Time	4	0-43200(sec.)	0 (Not auto off) (Max 12 hours)
5	Set whether to remember the last status of Relay 1	1	1/0	1:Remember (0: do not remember)
6	Set whether to remember the last status of Relay 2	1	1/0	1:Remember (0: do not remember)

COMMAND CLASSES

The module supports Command Classes including -

- COMMAND_CLASS_ZWAVEPLUS_INFO_V2
- COMMAND_CLASS_ASSOCIATION_V2
- COMMAND_CLASS_ASSOCIATION_GRP_INFO
- COMMAND_CLASS_MULTI_CHANNEL_ASSOCIATION_V2
- COMMAND_CLASS_MULTI_CHANNEL
- COMMAND_CLASS_TRANSPORT_SERVICE_V2
- COMMAND_CLASS_VERSION_V2
- COMMAND_CLASS_MANUFACTURER_SPECIFIC_V2
- COMMAND_CLASS_DEVICE_RESET_LOCALLY
- COMMAND_CLASS_POWERLEVEL
- COMMAND_CLASS_SECURITY
- COMMAND_CLASS_SECURITY_2
- COMMAND_CLASS_SUPERVISION
- COMMAND_CLASS_FIRMWARE_UPDATE_MD_V4
- COMMAND_CLASS_NOTIFICATION_V4
- COMMAND_CLASS_CONFIGURATION
- COMMAND_CLASS_SWITCH_BINARY

END POINT 1/2

- COMMAND_CLASS_ZWAVEPLUS_INFO_V2
- COMMAND_CLASS_SWITCH_BINARY
- COMMAND_CLASS_ASSOCIATION_V2
- COMMAND_CLASS_ASSOCIATION_GRP_INFO
- COMMAND_CLASS_MULTI_CHANNEL_ASSOCIATION_V2
- COMMAND_CLASS_SUPERVISION

ADDITIONAL COMMAND CLASSES SUPPORTED

- Binary Switch: Refer to Basic.
- Multi Channel: To control 2 relay independently.
- Firmware Update: For OTA function.